

LOCATION

LAT 45° 08.61' LONG 114° 55.74'

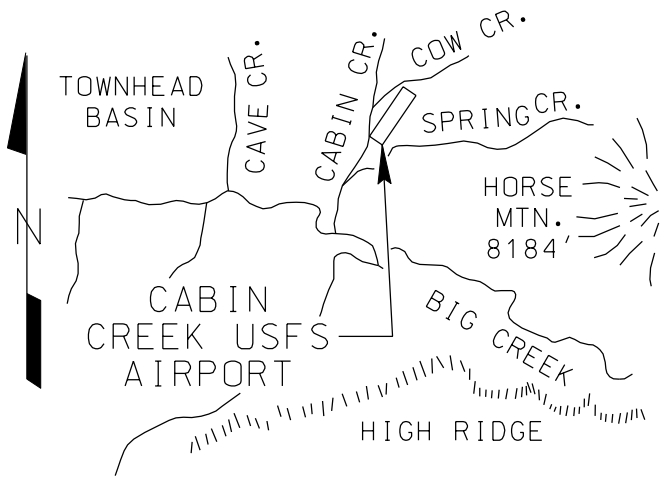

+20' BRUSH

LAYOUT

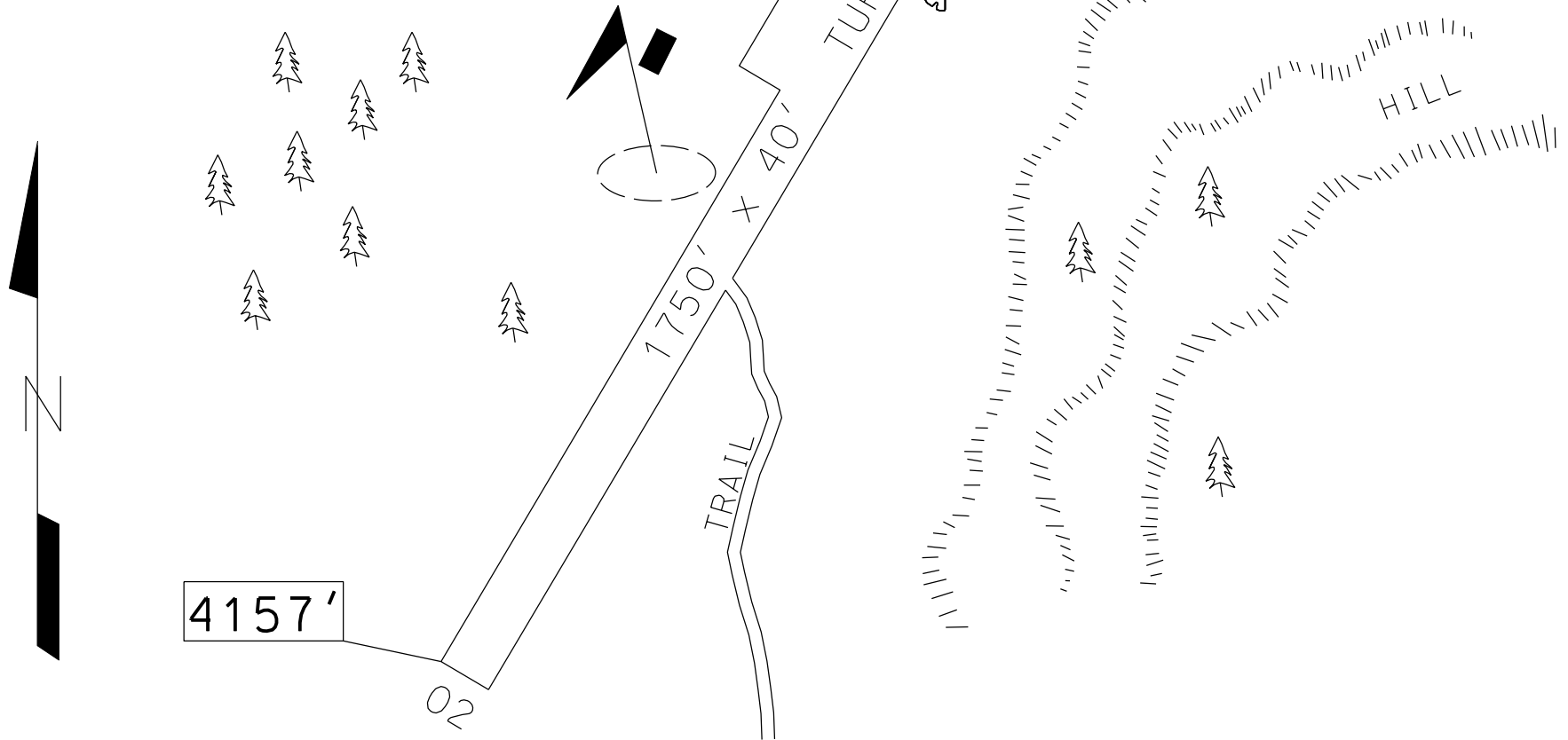

ELEVATION 4289

CTAF 122.9

LOCATION 37 MILES W OF SALMON

FUEL NO

VOR FREQ RAD NM
LKT 113.5 265° 36.5

SERVICES NO

COMMUNICATIONS CTAF 122.9

NAV AIDS NO

MANAGER 208-634-0700

LIGHTS NO

FBO(s) NO

ATTENDED NO

REMARKS LAND RWY 02, DEPART RWY 20. LANDING OR TAKEOFF WITH UNFAVORABLE WINDS NOT RECOMMENDED. CHECK AIRCRAFT PERFORMANCE FOR HIGH DENSITY ALTITUDE. GO-AROUND FROM FINAL NOT POSSIBLE DUE TO HIGH TERRAIN. STEEP ENCLOSING TERRAIN. RECOMMEND USE ONLY BY MOUNTAIN PROFICIENT PILOTS. WILDLIFE OR STOCK FREQUENTLY ON RUNWAY. NO WINTER MAINTENANCE.

11/09