

# JOHNSON CREEK

YELLOW PINE

# 3U2

### LOCATION

LAT 44° 54.73' LONG 115° 29.14'

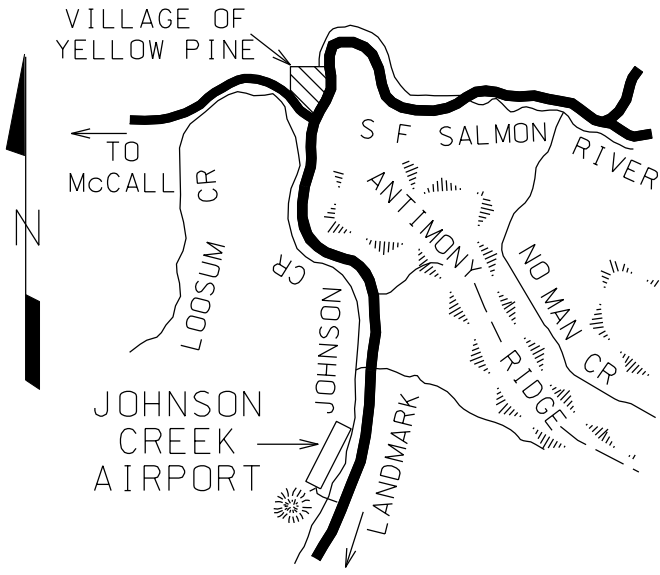

### LAYOUT

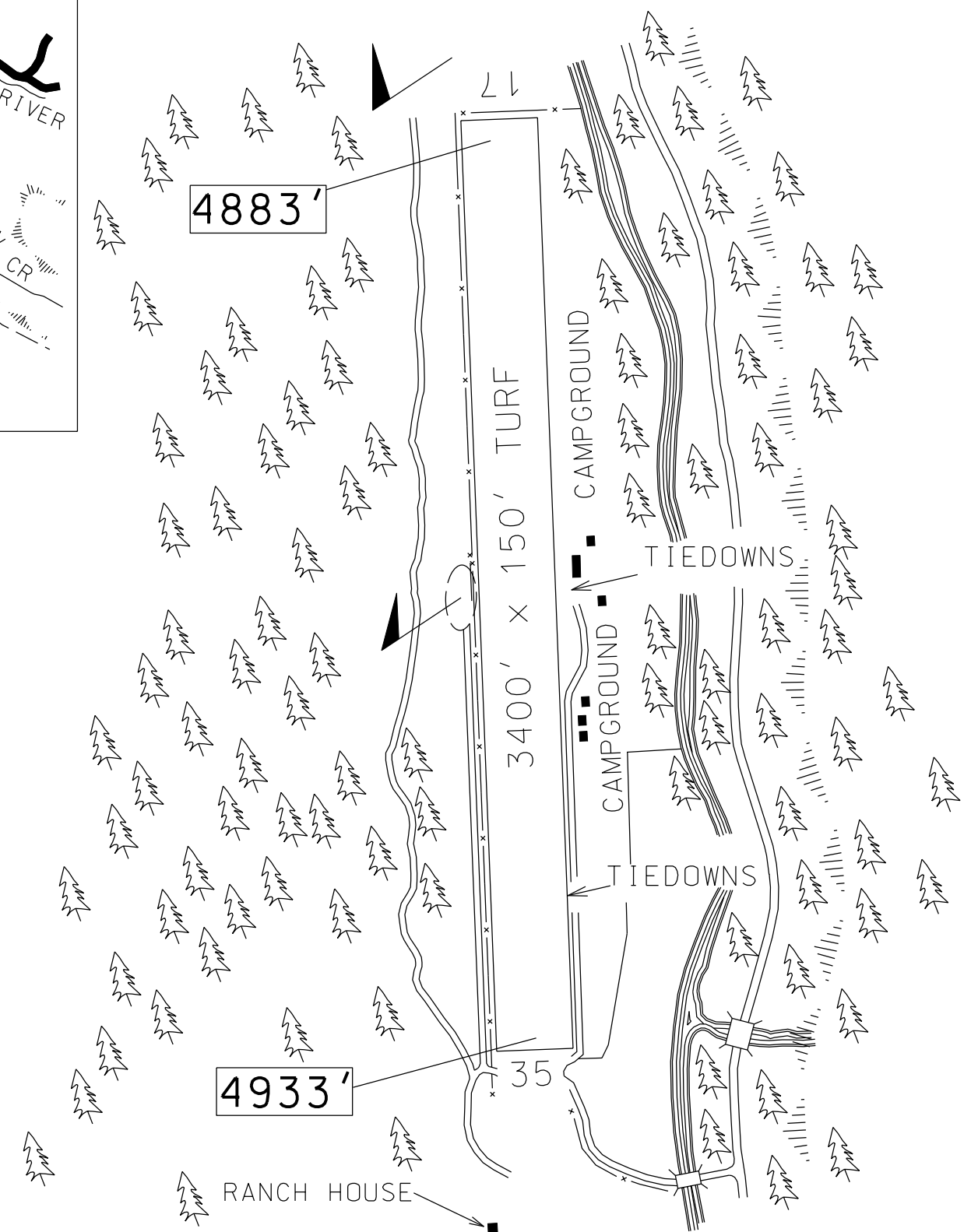

ELEVATION 4933

CTAF 122.9

LOCATION 3 MILES S OF YELLOW PINE

FUEL NO

<u>VOR</u>	<u>FREQ</u>	<u>RAD</u>	<u>NM</u>
DNJ	116.2	055°	32.0

SERVICES TIEDOWNS, COURTESY CAR, CAMPING, FOOD & LODGING ADJACENT AREA. PHONE AVAILABLE. 208-633-3333 FOR CONDITIONS.

COMMUNICATIONS CTAF 122.9

NAV AIDS NO

MANAGER  
208-334-8775, STATE OPERATED

LIGHTS NO

FBO(s) NO

ATTENDED NO

REMARKS NORMALLY LAND RWY 17, DEPART RWY 35. LANDINGS TO THE NORTH ARE ACCEPTABLE SHOULD CONDITIONS WARRANT. **AVOID** OVERFLYING THE RANCH HOUSE. TAKE OFF RWY 17 **STRONGLY** DISCOURAGED UNDER ANY CONDITIONS DUE TO RISING TERRAIN AND OBSTACLES. AVOID OVERFLYING THE VILLAGE OF YELLOW PINE BELOW 1000' AGL. WATCH FOR SPRINKLERS ON RWY. NO WINTER MAINTENANCE. RUNWAY MAY NOT BE VISIBLE FROM ALL PARTS OF THE TRAFFIC PATTERN.

1/2011

# JOHNSON CREEK

YELLOW PINE

# 3U2