

LOWER LOON

LOCATION

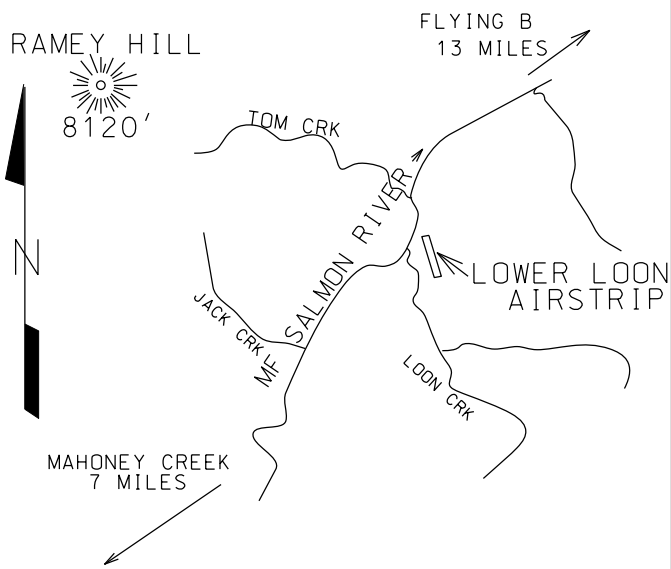

LAT 44° 48.46' LONG 114° 48.55'

LAYOUT

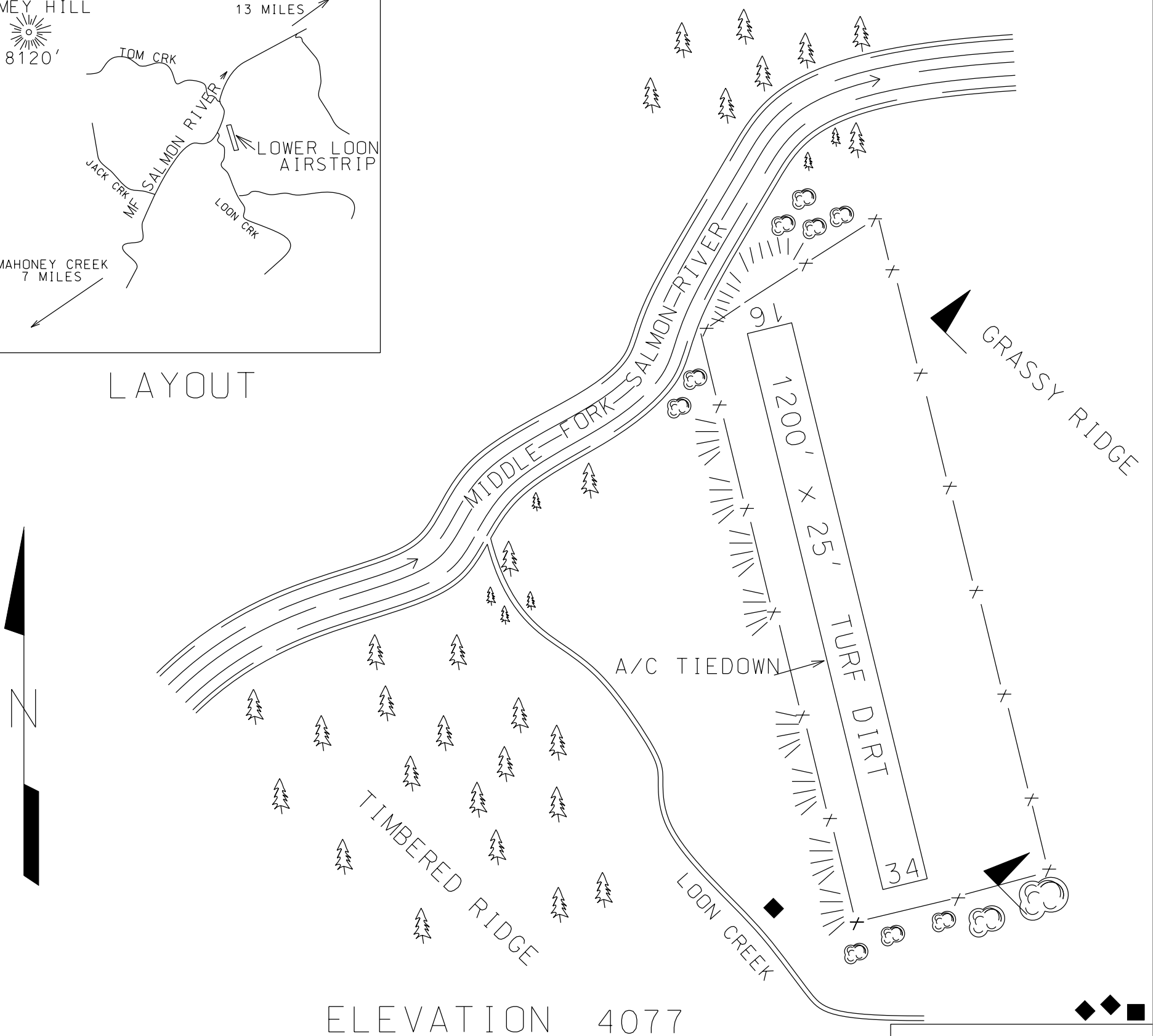

ELEVATION 4077

CTAF 122.9

LOCATION 42 MILES N OF STANLEY

FUEL NO

VOR FREQ RAD NM
LKT 113.5 229° 43.0

SERVICES 1 SET TIEDOWNS

COMMUNICATIONS CTAF 122.9

NAV AIDS NO

MANAGER
208-334-3700, STATE OPERATED

LIGHTS NO

FBO(s) NO

ATTENDED NO

REMARKS RECOMMEND LAND RUNWAY 16, DEPART RWY 34. STEEP ENCLOSING TERRAIN. BE PREPARED FOR DOWNDRAFTS OVER RIVER ON FINAL APPROACH TO RUNWAY 16. WILDLIFE OR STOCK FREQUENTLY ON RUNWAY. NO WINTER MAINTENANCE. RODENT ACTIVITY ALONG RUNWAY EDGES.