

LOCATION

LAT 44° 36.62' LONG 113° 53.69'

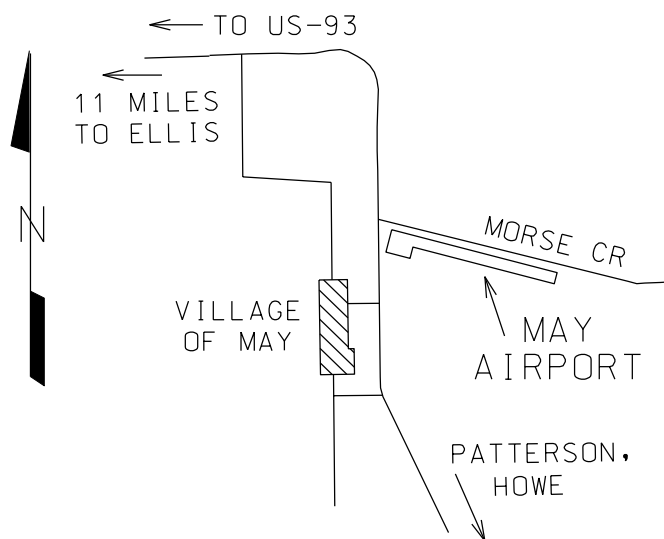

LAYOUT

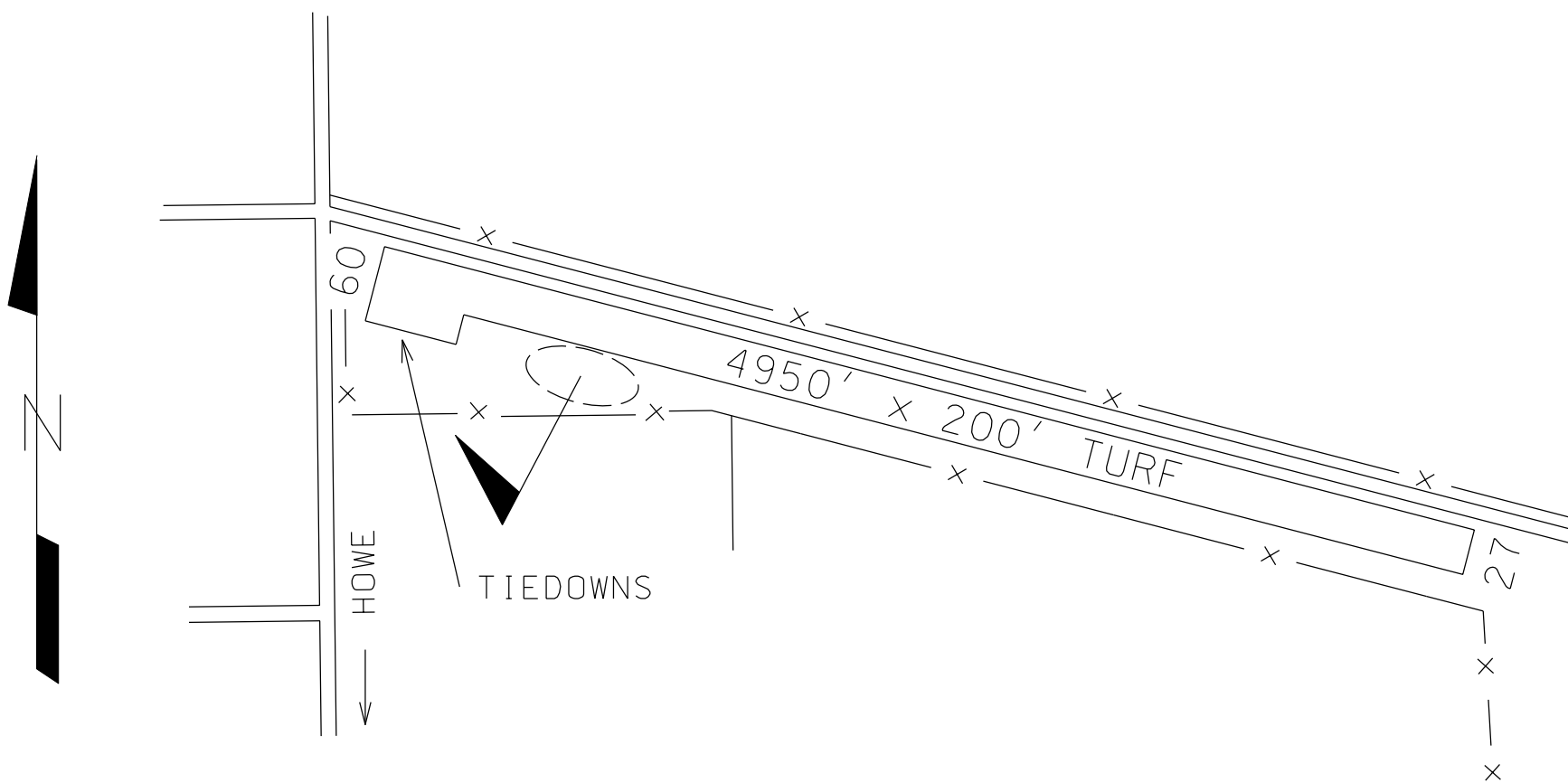

ELEVATION 5324

CTAF 122.9

LOCATION 1 MILE NE OF MAY

FUEL NO

VOR FREQ RAD NM
LKT 113.5 145° 26.0

SERVICES
TIEDOWNS

COMMUNICATIONS CTAF 122.9

NAV AIDS NO

MANAGER 208-334-8775, STATE OWNED

LIGHTS NO

FBO(s) NO

ATTENDED NO

REMARKS

RECOMMEND LAND RWY 09, DEPART RWY 27 WHEN WIND CONDITIONS PERMIT. AIRPORT LOCATED IN HIGH MOUNTAIN VALLEY SURROUNDED BY HIGH TERRAIN. RUNWAY SOFT WHEN WET. SUBJECT TO ONGOING DAMAGE BY LIVESTOCK, RODENTS AND GROUND VEHICLES. NO WINTER MAINTENANCE.

01/09