

MOOSE CREEK USFS

1U1

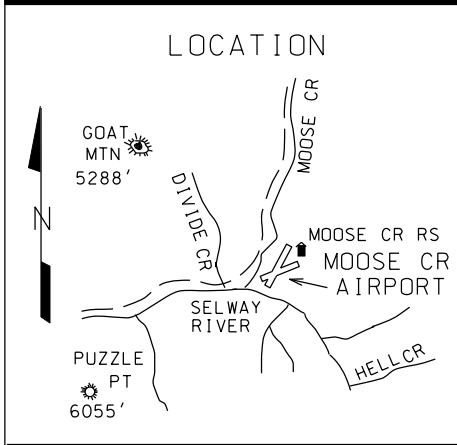

LAT 46°07.25' LONG 114°55.64'

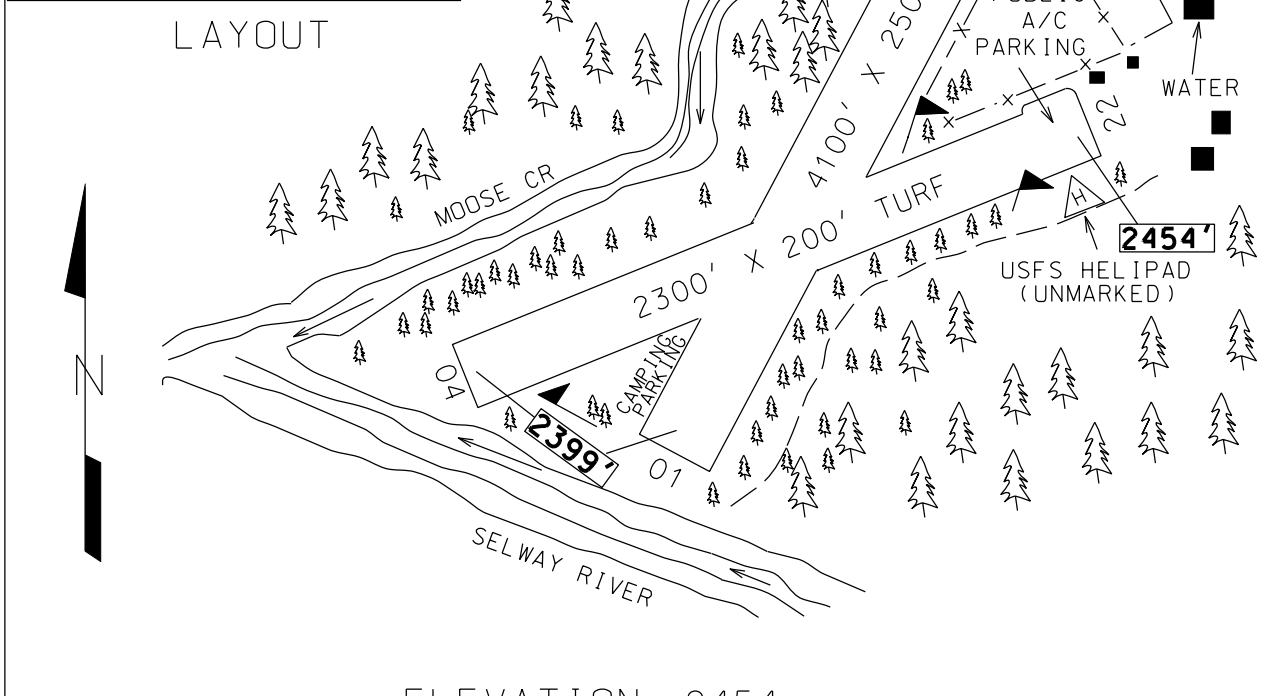

ELEVATION 2454

CTAF 122.9

<u>LOCATION</u> ADJ. SW OF RANGER STA.				<u>FUEL</u> NO	
<u>VOR</u>	<u>FREQ</u>	<u>RAD</u>	<u>NM</u>	<u>SERVICES</u>	
MSO	112.8	200°	57.5	PARKING AREAS DO NOT HAVE TIEDOWN CHAINS	
<u>COMMUNICATIONS</u> CTAF 122.9				<u>MANAGER</u> 208-983-9571	
<u>NAV AIDS</u> NO				FOR RWY CONDITIONS- 208-926-4258	
<u>LIGHTS</u> NO				<u>FBO(s)</u>	
<u>ATTENDED</u> NO				NO	

REMARKS NORMALLY LAND RWY 19, DEPART RWY 01. RUNWAY 01/19 MUDDY IN SPRING. LAND RWY 04, DEPART RWY 22, GO AROUND NOT RECOMMENDED. OPEN TO SKI-EQUIPPED AIRCRAFT ON SNOW. RWYS SUBJECT TO TEMPORARY CLOSURE. RUNWAYS MAY NOT BE VISIBLE FROM ALL PARTS OF THE TRAFFIC PATTERN. NO LINE OF SIGHT BETWEEN RUNWAY ENDS. WILDLIFE OR STOCK FREQUENTLY ON RUNWAYS. NO WINTER MAINTENANCE.

MOOSE CREEK USFS

1U1