

LAT 44° 53 39.64

LONG 115° 42 48.42

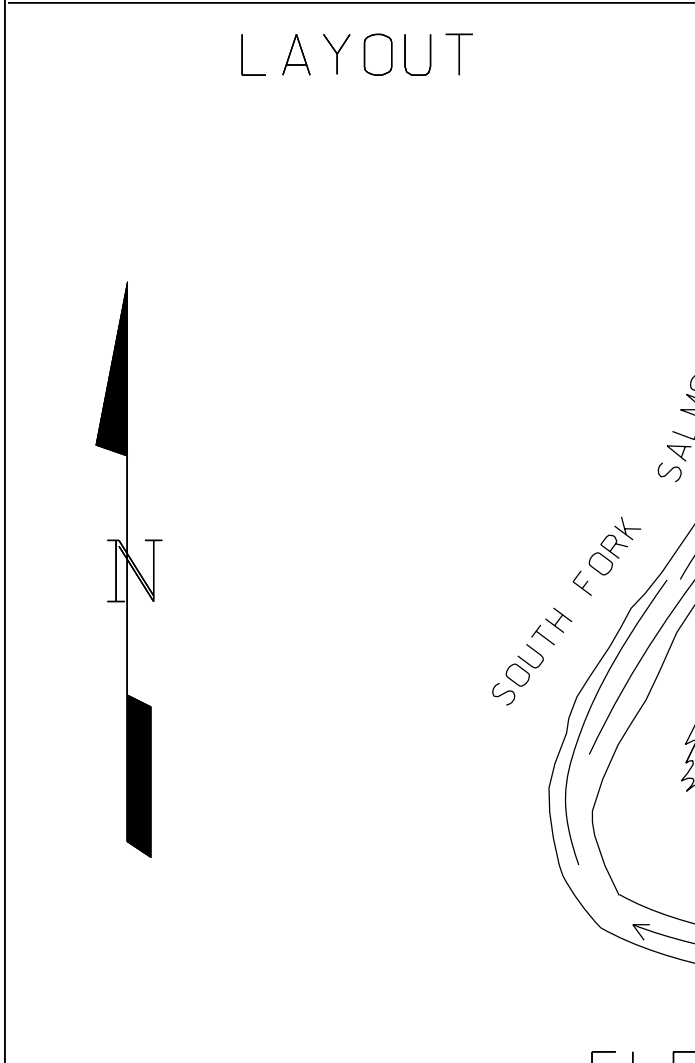

ELEVATION 4157

CTAF 122.9

LOCATION

20 MILES EAST OF McCALL

<u>VOR</u>	<u>FREQ</u>	<u>RAD</u>	<u>NM</u>
DNJ	116.2	51°	26

COMMUNICATIONS CTAF 122.9

NAV AIDS NONE

LIGHTS NONE

ATTENDED NONE

FUEL NONE

SERVICES TIEDOWNS, CAMPING  
OUTHOUSE, NO POTABLE WATER

MANAGER ID DIV OF AERONAUTICS  
208-334-8775

FBO(s)  
NONE

REMARKS NORMALLY LAND RWY 16, DEPART RWY 34. AIRPORT CLOSED TO NON-EMERGENCY OPERATIONS FROM NOV 1 THROUGH APRIL 30. RWY 16-34 EDGES AND THRESHOLD MARKED WITH WHITE ROCK. BE ALERT FOR HELICOPTER AND FIXED WING OPERATIONS AT KRASSEL USFS AIRPORT 6 MILES NORTH. NO LINE OF SIGHT BETWEEN RUNWAY ENDS.